

# **Petro 3003**

## **Skrócona instrukcja**

### **VOLUTANK**

(Without SAFE, with wet hose, with collector draining, with company select)

Softwareversion PYRAMIDE 2.5.x

KBA 210330

**PLEASE NOTE**

*This document is a short version of the product operation. It must be kept in the immediate vicinity of the device so that access to it is possible at any time.*

*To be observed safety and more detailed instructions, see the operation manual.*

*The current version can be downloaded from [www.bartec.de](http://www.bartec.de) or requested from BARTEC BENKE GmbH.*

# Ładowanie bez SAFE

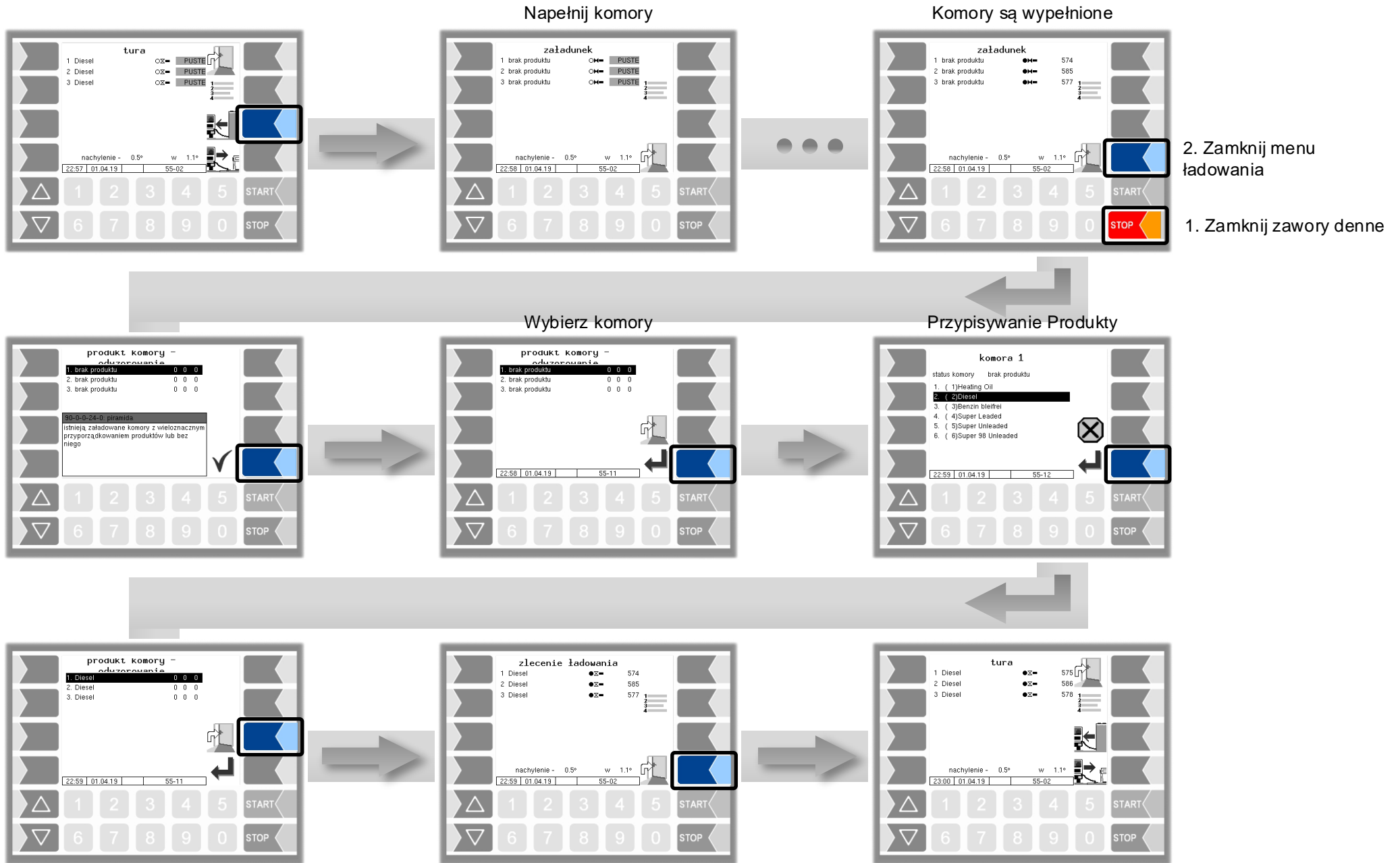

# Ładowanie z wybór koncernu

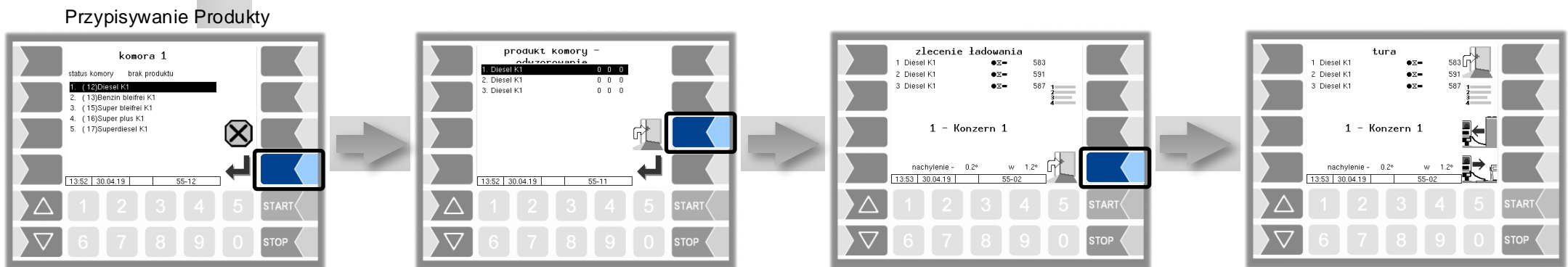
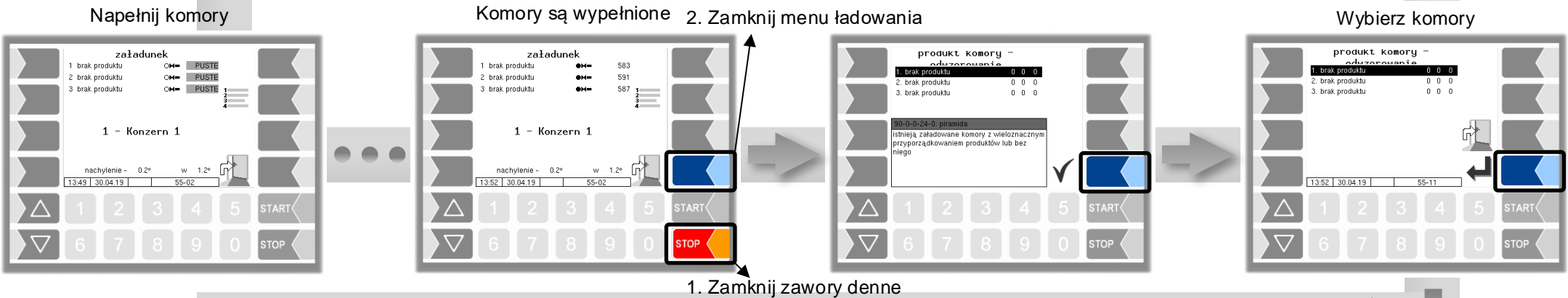
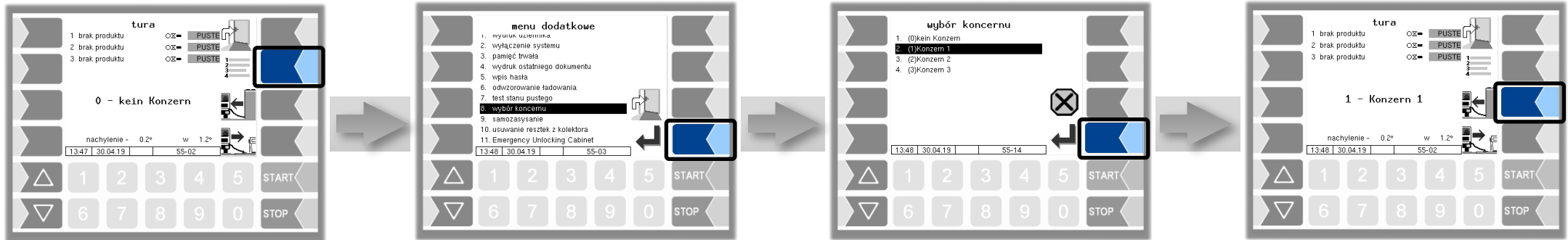

# Dostawa bez SAFE

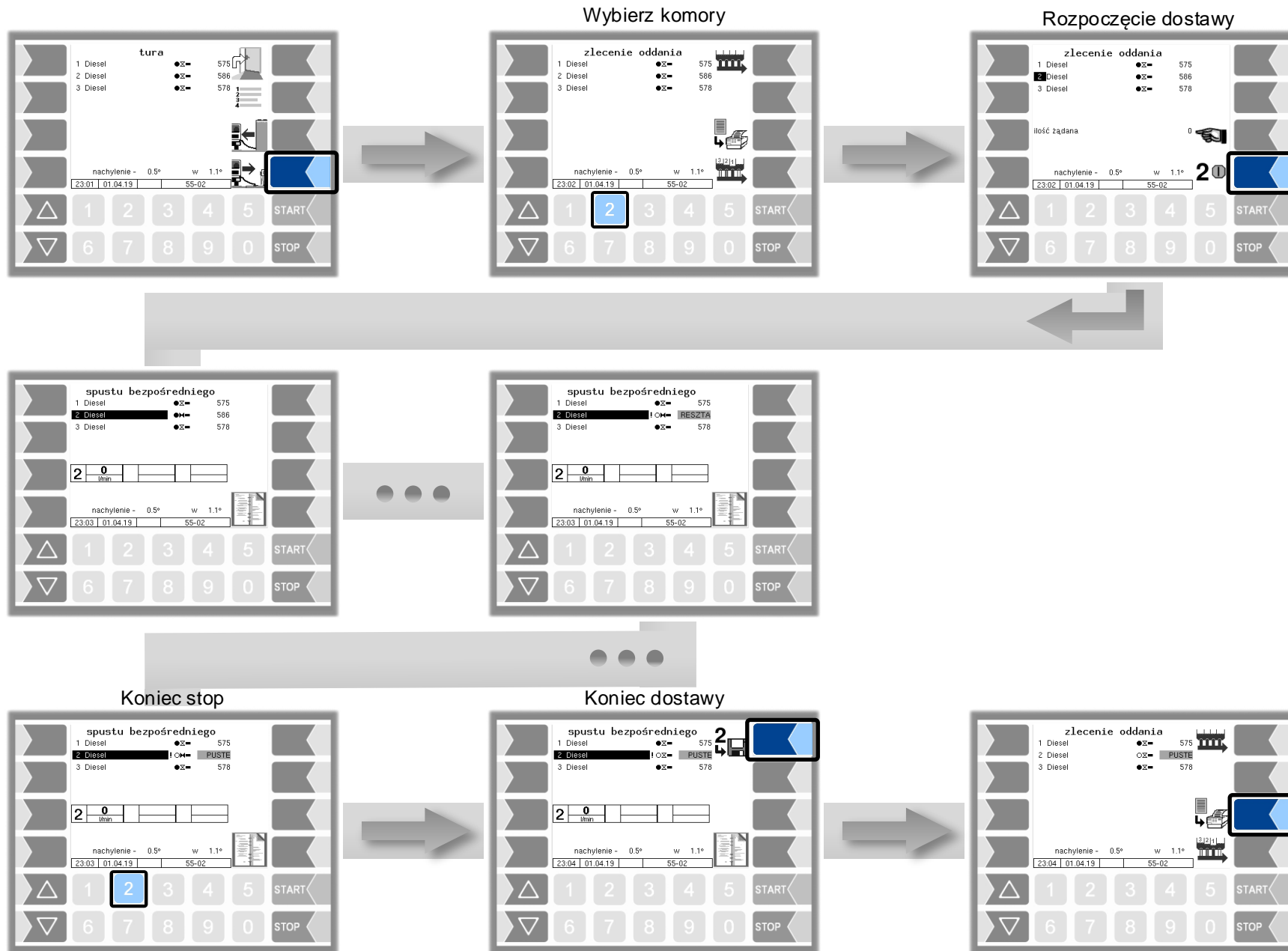

# Dostawy z pełnym węzłem - jednocześnie

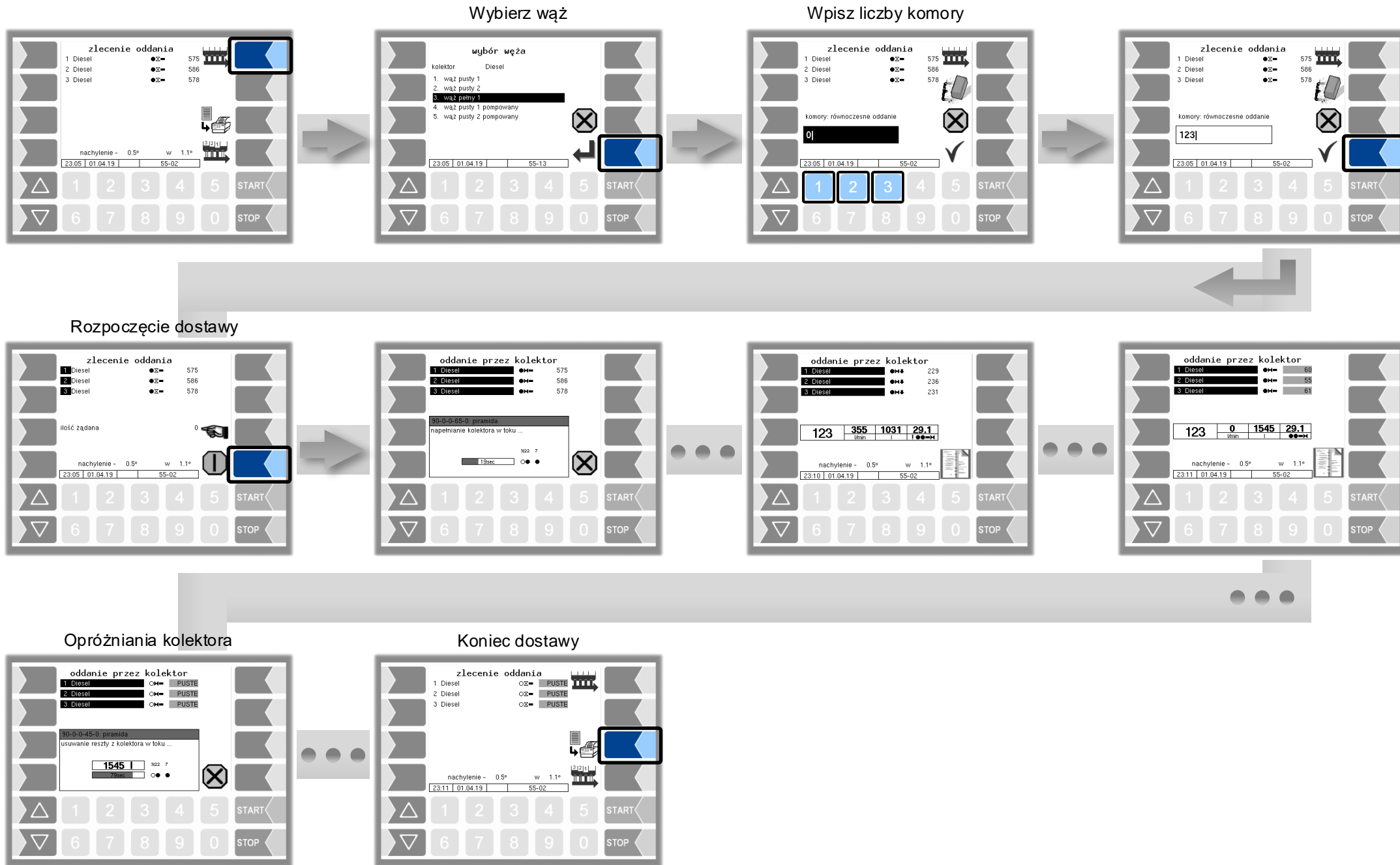

# Dostawy z pełnym węzłem - kolejno



# Dostawy z pełnym węzłem - częściowo

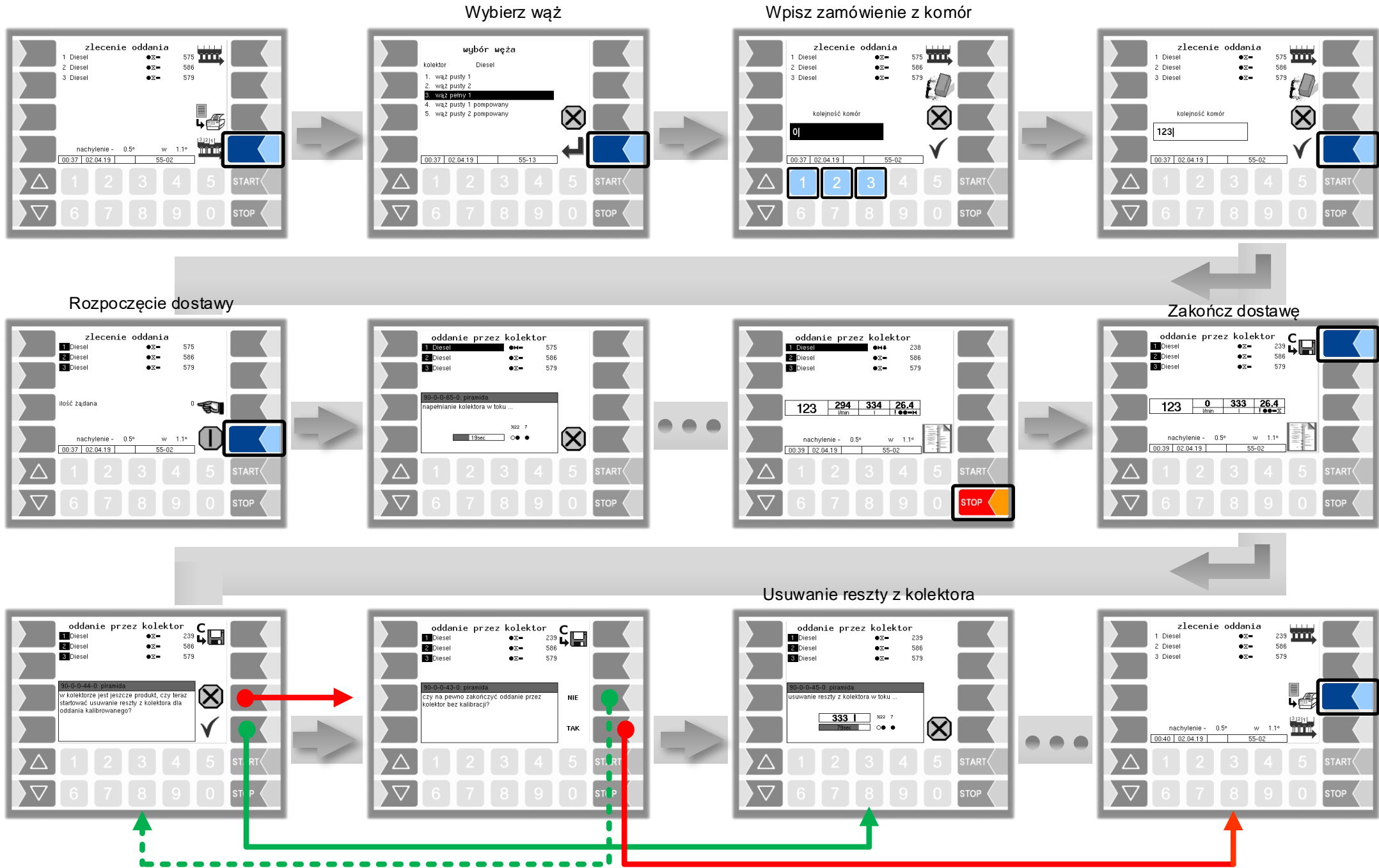



# Opróżniania kolektora

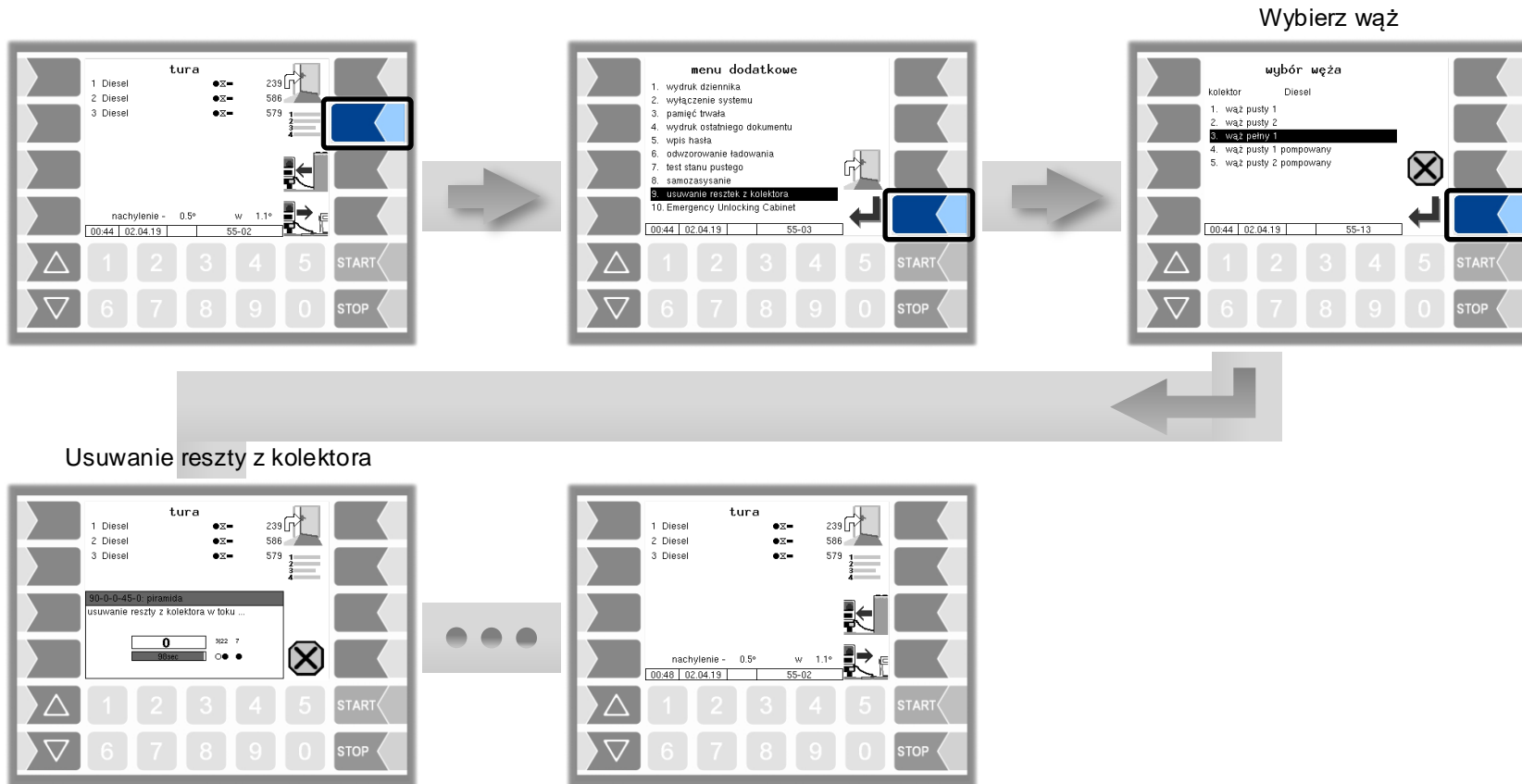

# Display of operating states

